

6022-2Z Deep groove ball bearings

- Popular item
- SKF Explorer

Deep groove ball bearings

Bearing data

[Tolerances](#),

Normal (metric), P6, P5, Normal (inch),

[Radial internal clearance](#),

Matched bearing pairs, Stainless steel
 $d < 10$ mm, Other bearings

Bearing interfaces

[Seat tolerances for standard conditions](#),

[Tolerances and resultant fits](#)

Technical specification

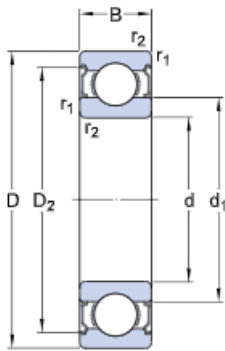

DIMENSIONS

d	110 mm	Bore diameter
D	170 mm	Outside diameter
B	28 mm	Width
d_1	≈ 129.05 mm	Shoulder diameter
D_2	≈ 155.3 mm	Recess diameter
$r_{1,2}$	min. 2 mm	Chamfer dimension

ABUTMENT DIMENSIONS

d_c min.	119 mm	Diameter of shaft abutment
d_c max.	128.9 mm	Diameter of shaft abutment
D_i max.	161 mm	Diameter of housing abutment
r_a max.	2 mm	Radius of shaft or housing fillet

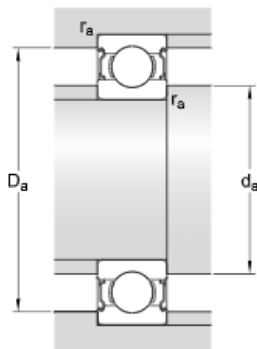

CALCULATION DATA

C	85.2 kN	Basic dynamic load rating
C ₀	73.5 kN	Basic static load rating
P _u	2.6 kN	Fatigue load limit
	8 000 r/min	Reference speed
	4 000 r/min	Limiting speed
k _r	0.025	Minimum load factor
f ₀	15.6	Calculation factor

MASS

	2.06 kg	Mass bearing
--	---------	--------------

TOLERANCE CLASS

P6	Dimensional tolerances
Normal	Radial run-out